

HOEFLON S800 - handling loads of up to 800 kg

The Hoeflon S800 suction lifter is a premium quality multifunctional glass lifter. It can be used as both a spider and inline suction lifter. At just 82kg, it is the lightest suction lifter in its class.

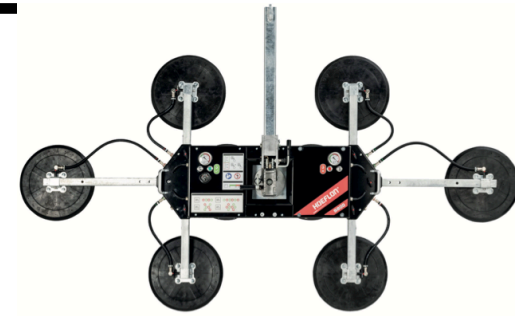

Lifting capacity double circuit:	200 - 800 kg
Machine weight:	55 - 80 kg
Rotation / Tilt range:	360° with four locking positions / 90° with six locking positions
Battery:	12VDC, 10Ah

The Hoeflon S800's extra-short lifting arm provides very compact dimensions for when glass installation space is limited. The overall width of the machine is also very low, meaning that work can be carried out in tight spaces, such as working between facades and scaffolding. The angle adjustment on the Hoeflon lifting arm provides extra safety and convenience for indoor glazing installation because the angle can be fixed in different positions. Its double vacuum circuit, meeting the requirements of the EN 13155 directive, ensures maximum safety and installation speed because external load fall arrester is no longer necessary.

Configurations:

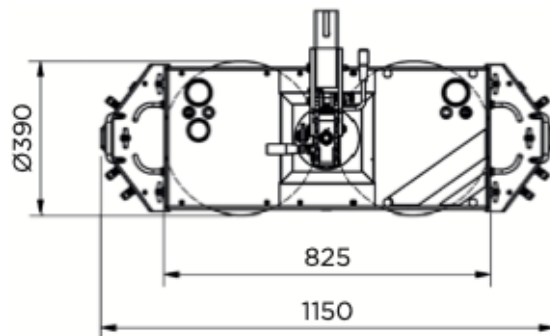

Capacity 200kg

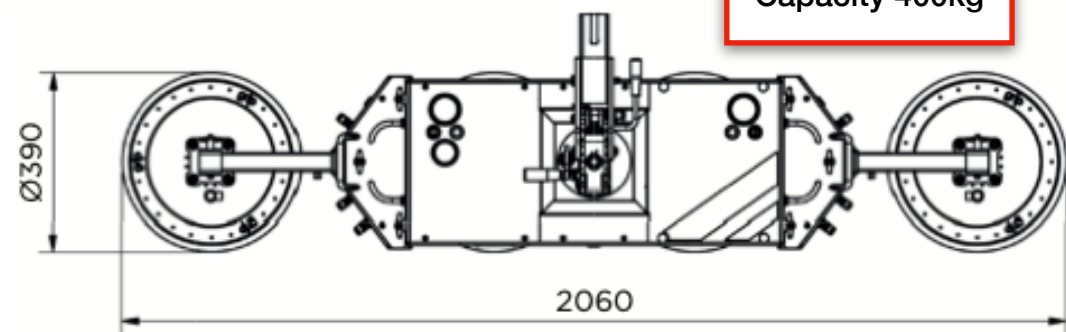

Capacity 400kg

Configurations continued:

